

PennAccess: John Morgan Building

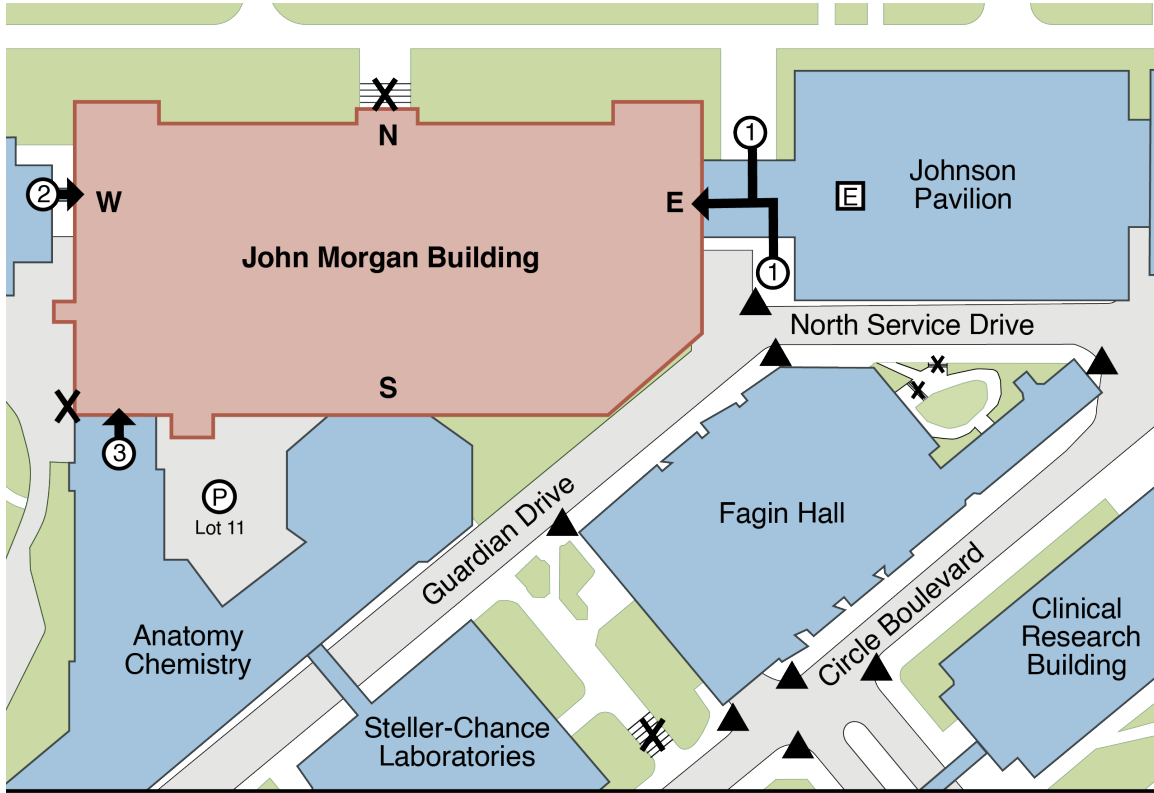

North



Wheelchair Accessible Entrance
Number corresponds to text above



Elevator



Barrier



Curb Cut



Permit Parking



Public Parking

Entrance Information:

3620 Hamilton Walk. Philadelphia. PA. 19104

1. This is the main entrance to John Morgan building. The Johnson Pavilion entrance provides level or ramped passages to the basement, first, second and third floors of John Morgan Building. This entrance is located off Hamilton Walk on the north side of Johnson Pavilion and off Guardian Drive and North Service Drive on the south side of Johnson Pavilion. This entrance should be used when approaching John Morgan Building from the east side of the building.
2. The west entrance into Richard Laboratories is through its main entrance and its PennCard access only. There are level passageways from Richards Laboratories into John Morgan Building on the first and second floors. This entrance should be used when approaching John Morgan Building from the west side of the building.
3. There is an internal level passage between Anatomy Chemistry Building and John Morgan Building on the second floor and its PennCard access only.

Note: The north entrance have stairs and its PennCard access only.

Elevator Information:

- There are no elevators in the John Morgan Building.

- The elevators in Johnson Pavilion provide access to all floors of John Morgan Building, except the mezzanine.
- The elevators in Richards Laboratories provide access to all floors of John Morgan Building, except the third floor and the mezzanine.

Accessible Restrooms:

- Basement - men's and women's
- First floor - women's
- Second floor - men's

Building Information:

- John Morgan Building is directly connected to Johnson Pavilion, Richards Laboratories and Anatomy Chemistry Building and through them to the rest of the Medical Complex.
- Most areas are PennCard access only and are private/graduate laboratories.
- The mezzanine, which is mostly offices, is not handicapped accessible.
- There are two lecture halls in the basement that are tiered and have ramped or level entrances and areas for people using wheelchairs.
- Contact the Building Manager at 215.898.8260, for more information.